

Soils Map

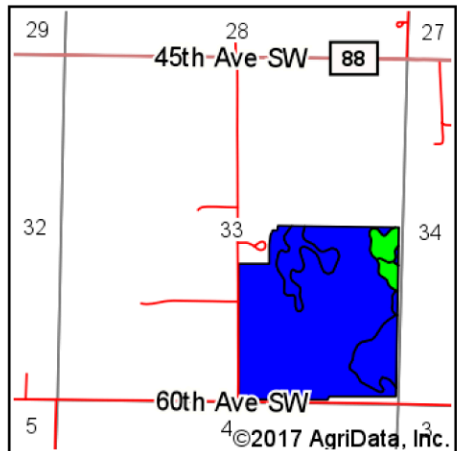

State: **Minnesota**
 County: **Kandiyohi**
 Location: **33-119N-35W**
 Township: **Willmar**
 Acres: **144.73**
 Date: **7/5/2017**

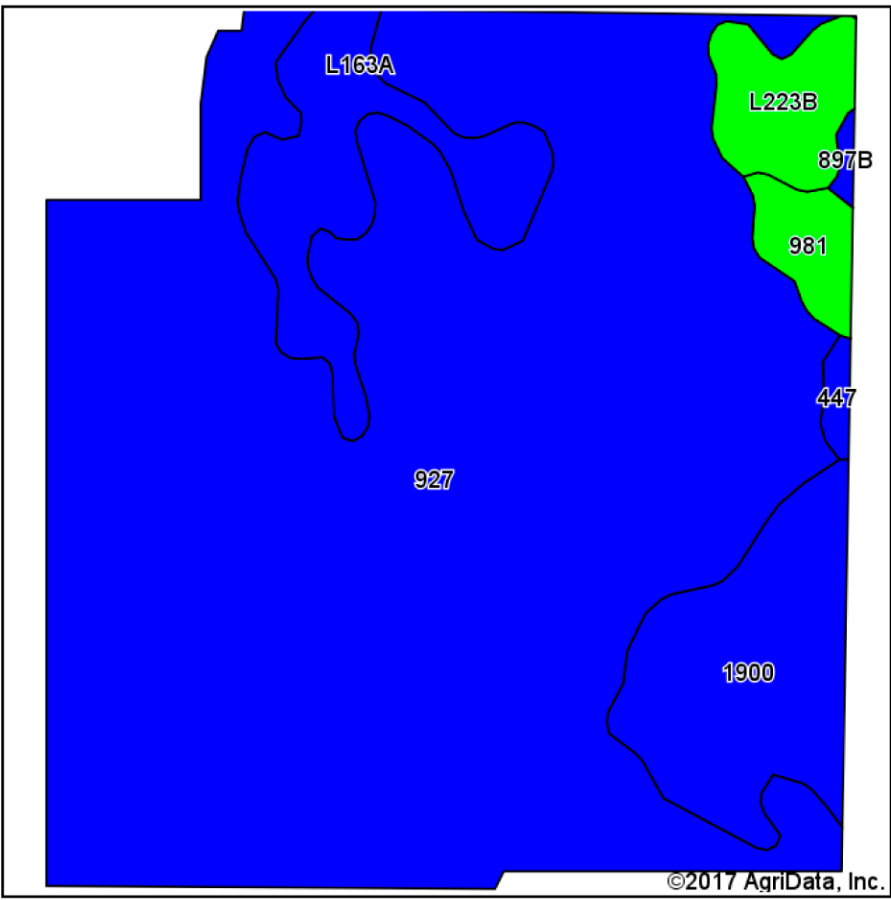

Maps Provided By:

 CUSTOMIZED ONLINE MAPPING
 © AgriData, Inc. 2017 www.AgriDataInc.com



Soils data provided by USDA and NRCS.

Area Symbol: MN067, Soil Area Version: 15

Code	Soil Description	Acres	Percent of field	PI Legend	Non-Irr Class *c	Productivity Index	Bromegrass alfalfa	Bromegrass alfalfa hay	Cor n	Oats	Soybeans	Spring wheat
927	Harps-Glencoe-Seaforth complex, 0 to 3 percent slopes	115.18	79.6%		IIw	90						
1900	Okoboji-Canisteo depressional complex, 0 to 1 percent slopes	12.34	8.5%		IIIw	86						
L163A	Okoboji silty clay loam, 0 to 1 percent slopes	9.60	6.6%		IIIw	86						
L223B	Amiret-Swanlake loams, 2 to 6 percent slopes	4.26	2.9%		Ile	92						
981	Canisteo-Harps loams	2.41	1.7%		IIw	92	4.9	3.8	168	81	50	48
447	Harpster silty clay loam	0.63	0.4%		IIw	90	5.1	3.8	165	82	50	49
897B	Seaforth-Swanlake loams, 2 to 6 percent slopes	0.31	0.2%		IIIs	90	5.4	4.2	165	85	50	52
Weighted Average						89.5	0.1	0.1	3.9	1.9	1.2	1.1

*c: Using Capabilities Class Dominant Condition Aggregation Method

Soils data provided by USDA and NRCS.