

# Soils Map

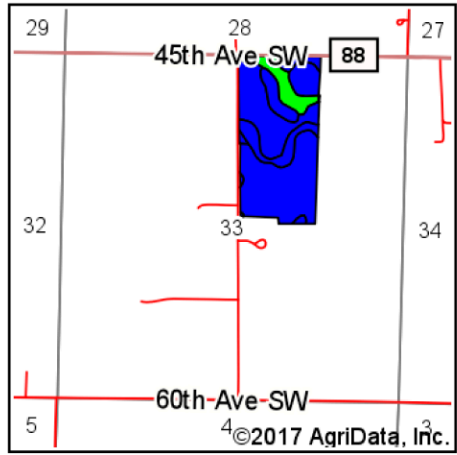

State: **Minnesota**  
 County: **Kandiyohi**  
 Location: **33-119N-35W**  
 Township: **Willmar**  
 Acres: **71.53**  
 Date: **7/5/2017**

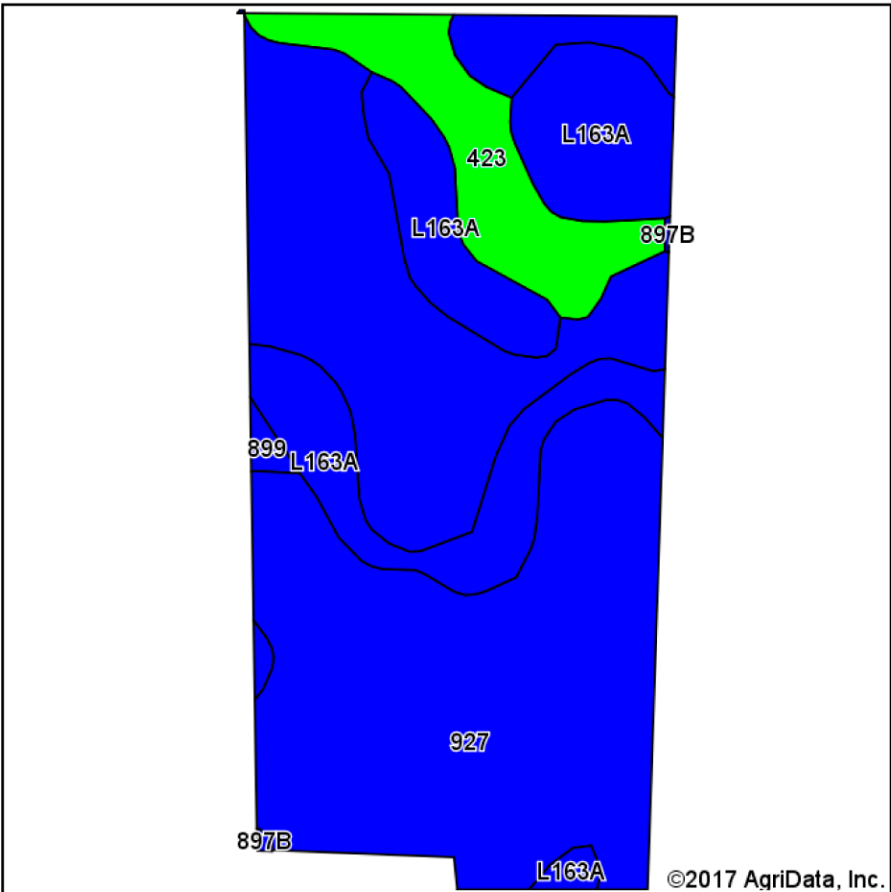

Maps Provided By:  
  
 CUSTOMIZED ONLINE MAPPING  
 © AgriData, Inc. 2017 [www.AgriDataInc.com](http://www.AgriDataInc.com)



Soils data provided by USDA and NRCS.

©2017 AgriData, Inc.

Area Symbol: MN067, Soil Area Version: 15

Code	Soil Description	Acres	Percent of field	PI Legend	Non-Irr Class *c	Productivity Index	Bromegrass alfalfa	Bromegrass alfalfa hay	Cor n	Oats	Soybeans	Spring wheat
927	Harps-Glencoe-Seaforth complex, 0 to 3 percent slopes	48.44	67.7%		IIw	90						
L163A	Okoboji silty clay loam, 0 to 1 percent slopes	15.53	21.7%		IIIw	86						
423	Seaforth loam, 1 to 3 percent slopes	6.91	9.7%		IIs	95						
899	Harps-Okoboji complex, 0 to 2 percent slopes	0.56	0.8%		IIw	89						
897B	Seaforth-Swanlake loams, 2 to 6 percent slopes	0.09	0.1%		IIs	90	5.4	4.2	165	85	50	52
<b>Weighted Average</b>						<b>89.6</b>	<b>*-</b>	<b>*-</b>	<b>0.2</b>	<b>0.1</b>	<b>0.1</b>	<b>0.1</b>

\*c: Using Capabilities Class Dominant Condition Aggregation Method

Soils data provided by USDA and NRCS.