

# Soils Map

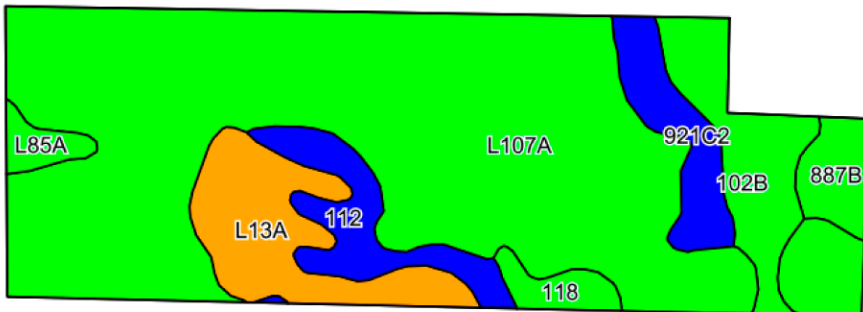

©2019 AgriData, Inc.

Soils data provided by USDA and NRCS.

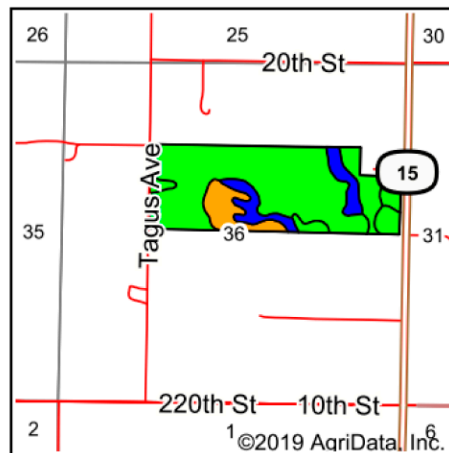

State: **Minnesota**  
 County: **McLeod**  
 Location: **36-114N-30W**  
 Township: **Round Grove**  
 Acres: **111.12**  
 Date: **9/11/2019**



Maps Provided By:



© AgriData, Inc. 2019

www.AgriDataInc.com



Area Symbol: MN085, Soil Area Version: 16

Code	Soil Description	Acres	Percent of field	PI Legend	Non-Irr Class *c	Productivity Index	*n NCCPI Soybeans
L107A	Canisteo-Glencoe complex, 0 to 2 percent slopes	73.67	66.3%		IIw	91	79
L13A	Klossner muck, 0 to 1 percent slopes	10.50	9.4%		IIIw	77	90
102B	Clarion loam, 2 to 6 percent slopes	8.37	7.5%		Ile	95	83
112	Harps clay loam, 0 to 2 percent slopes	6.36	5.7%		IIw	90	77
921C2	Clarion-Storden complex, 6 to 10 percent slopes, moderately eroded	5.35	4.8%		IIIe	87	65
887B	Clarion-Swanlake complex, 2 to 6 percent slopes	3.21	2.9%		Ile	92	82
118	Crippin loam, 1 to 3 percent slopes	2.05	1.8%		Ie	100	84
L85A	Nicollet clay loam, 1 to 3 percent slopes	1.61	1.4%		Iw	99	78
<b>Weighted Average</b>						<b>90</b>	<b>*n 79.7</b>

\*n: The aggregation method is "Weighted Average using major components"

\*c: Using Capabilities Class Dominant Condition Aggregation Method

Soils data provided by USDA and NRCS.