

Soils Map

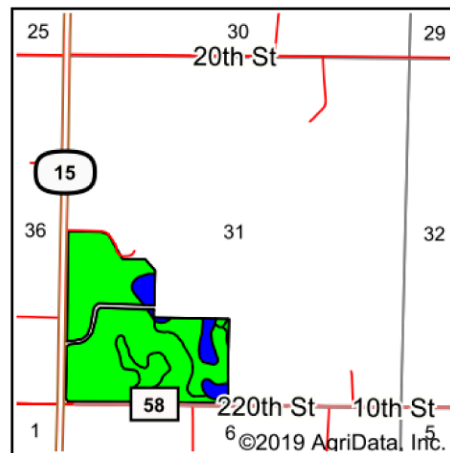

State: **Minnesota**
 County: **McLeod**
 Location: **36-114N-30W**
 Township: **Round Grove**
 Acres: **102.37**
 Date: **9/11/2019**

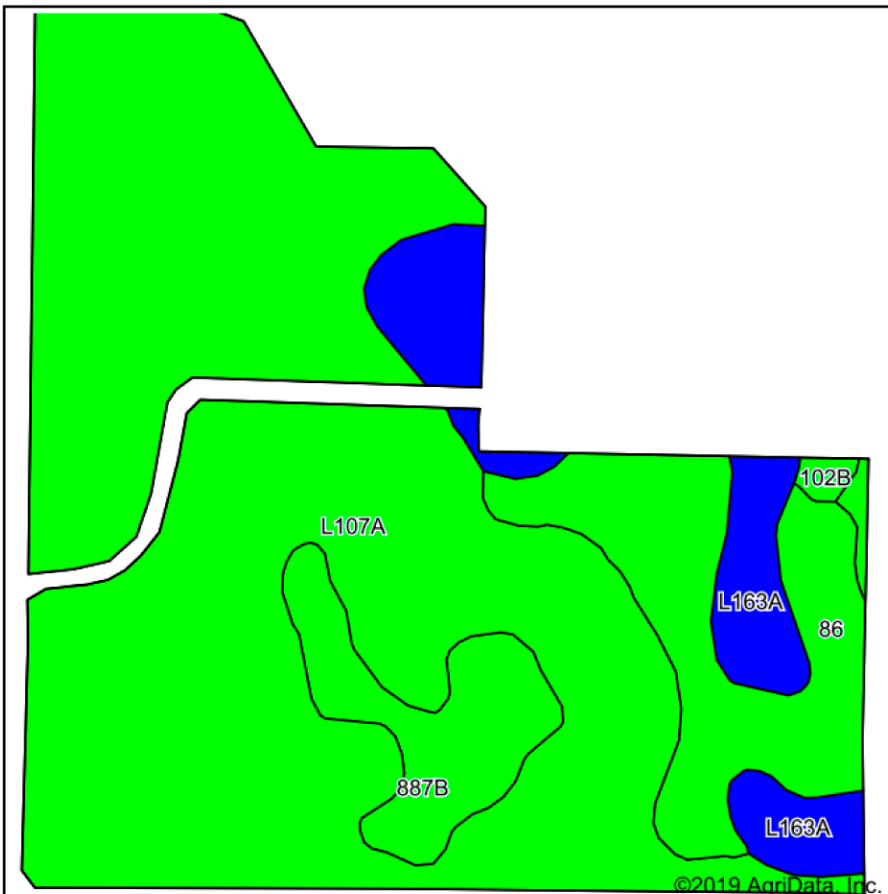

Maps Provided By:



Area Symbol: MN085, Soil Area Version: 16

Code	Soil Description	Acres	Percent of field	PI Legend	Non-Irr Class *c	Productivity Index	*n NCCPI Soybeans
L107A	Canisteo-Glencoe complex, 0 to 2 percent slopes	73.49	71.8%		IIw	91	79
86	Canisteo clay loam, 0 to 2 percent slopes	12.87	12.6%		IIw	93	79
L163A	Okoboji silty clay loam, 0 to 1 percent slopes	8.77	8.6%		IIIw	86	77
887B	Clarion-Swanlake complex, 2 to 6 percent slopes	6.82	6.7%		Ile	92	82
102B	Clarion loam, 2 to 6 percent slopes	0.42	0.4%		Ile	95	83
Weighted Average						90.9	*n 79

*n: The aggregation method is "Weighted Average using major components"

*c: Using Capabilities Class Dominant Condition Aggregation Method

Soils data provided by USDA and NRCS.