

# Soils Map

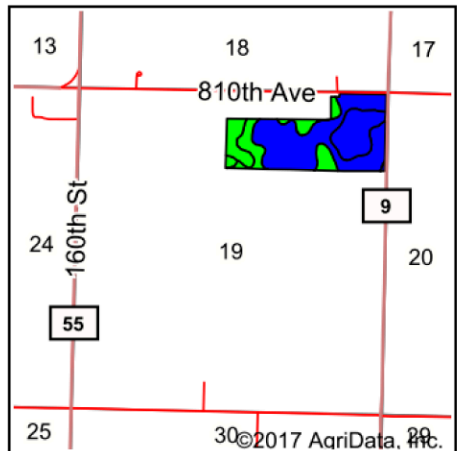

State: **Minnesota**  
 County: **Renville**  
 Location: **19-115N-37W**  
 Township: **Sacred Heart**  
 Acres: **59.52**  
 Date: **9/18/2017**

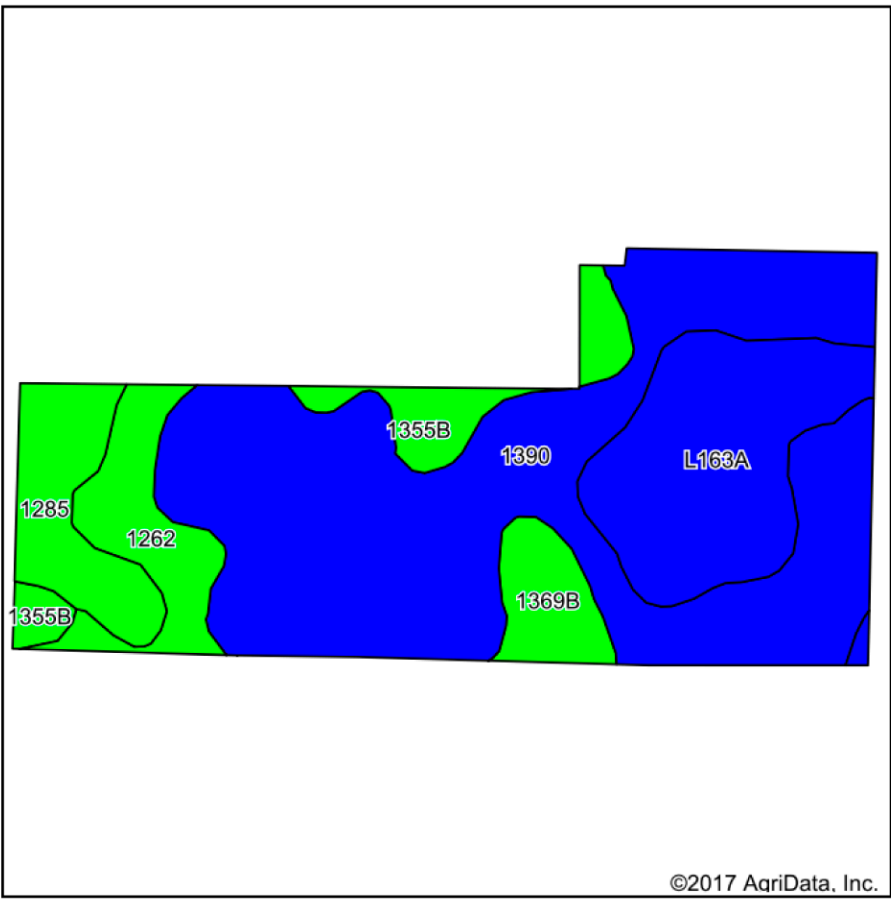

Maps Provided By:  
**surety**  
 CUSTOMIZED ONLINE MAPPING  
 © AgriData, Inc. 2017 [www.AgriDataInc.com](http://www.AgriDataInc.com)



Area Symbol: MN129, Soil Area Version: 13

Code	Soil Description	Acres	Percent of field	PI Legend	Non-Irr Class *c	Productivity Index	Bromegrass alfalfa	Bromegrass alfalfa hay	Corn	Oats	Reed canarygrass	Soybeans	Spring wheat
1390	Leen silty clay loam, 0 to 2 percent slopes	32.66	54.9%		IIw	90	5.2	4	165	85		50	51
L163A	Okoboji silty clay loam, 0 to 1 percent slopes	11.12	18.7%		IIIw	86							
1285	Chetomba silty clay loam, 0 to 2 percent slopes	4.76	8.0%		IIw	92	5.3	4.1	168	88	5.5	51	52
1262	Seaforth silt loam, 1 to 3 percent slopes	4.60	7.7%		IIs	95							
1355B	Amiret-Swanlake loams, 2 to 6 percent slopes	3.64	6.1%		Ile	92							
1369B	Crooksford silt loam, 3 to 5 percent slopes	2.74	4.6%		Ile	100	6.1	4.7	183	90		55	54
<b>Weighted Average</b>						<b>90.4</b>	<b>3.6</b>	<b>2.7</b>	<b>112.4</b>	<b>57.8</b>	<b>0.4</b>	<b>34</b>	<b>34.6</b>

\*c: Using Capabilities Class Dominant Condition Aggregation Method

Soils data provided by USDA and NRCS.